

WB-200 Series

LIGHTWEIGHT HEADSET WAM-100/2L



FEATURES

- Microphone electret with noise cancelling system reducing the background noise.
- Incorporate listen volume level, mute button and clothing clip to reduce the cable weight.
- The headset is comfortable and secure.
- Incorporates adjustable headband and earloop to change between over-the-head and over-the-ear configuration.
- Mini XLR-4p connector. Cable 1,2 m. Weight 60 gr.

WBP-200 Recommended configuration.

- Set the microphone input to electret type: Open the unit and place one jumper in the connector marked as JP2 (PHANTOM).
- Adjust the microphone gain: Press and hold the MIC key, and with the VOLUME keys, adjust the level 5 points up from the minimum.

WBS-200 Recommended configuration.

- Set the microphone input to electret type: Open the unit and place one jumper in the connector marked as JP2 (PHANTOM).
- Adjust the microphone gain: Open the unit and remove the jumper in the connector marked as JP1 (GAIN).

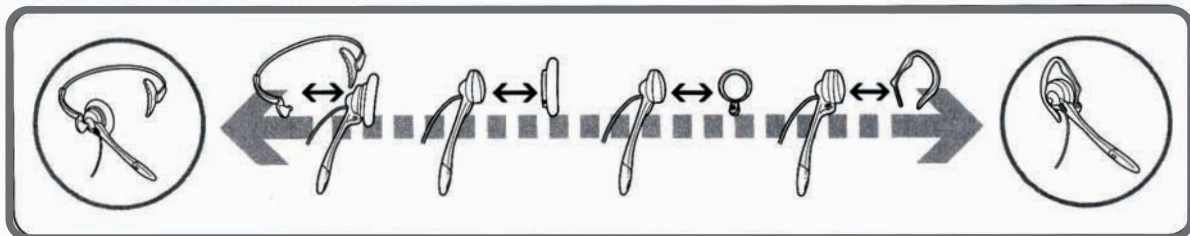

OVER THE HEAD ADJUSTMENT

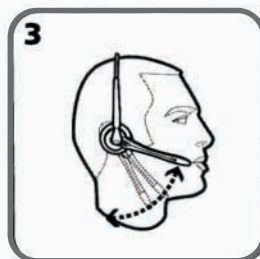

OVER THE EAR ADJUSTMENT

