

8-channel SD mobile video studio

MS-900



Datavideo MS-900 is a fully integrated mobile video studio designed around Datavideo SE-900 modular 8-channel SD switcher. The MS-900 feature set can be expanded with additional input cards and accessories as your requirements evolve.

The MS-900 accepts up to 8 SD inputs of your choice including DV, SDI, DVI*, YUV and Composite Video. Standard outputs include DV, SDI, YUV, S-Video (Y/C) and Composite Video. Thanks to a built in frame synchroniser and TBC for each channel no external genlock is required for flicker free switching between all 8 inputs - in any format. Optional genlock input card* is available for genlock to existing house reference. The Multi Image Preview output allows all 8 input channels and the PVW and PGM buses to be seen on one screen. The screen also features tally information, the live source is highlighted in Red and the cued source is highlighted in yellow. In addition each input card offers a Composite Video Preview Output, irrespective of the input type.

MS-900 features also include a down

stream keyer (DSK) for integration with character generator such as Datavideo CG-100. Overlay Keying can be performed internally or externally. A separate Logo Display can be used independently of the DSK utilising two built in stores.

An optional Chroma Key board can be fitted to add a 4 channel Chroma Key function. Each channel can be set independently, and you can seamlessly switch from one to another. This is ideal for virtual studio or newsroom type applications.

To accommodate for any delay in DV or SDI equipment SE-900 includes an audio delay function as well as a DV/SDI audio embedder for output. Additionally each DV and SDI video input has an audio de-embedder which provides dual channel balanced audio output.



FEATURES

- Complete integrated solution, including 8-channel SD switcher, multi display monitor, hard drive recorder and talk back system with built in tally feature
- Multi-format video – up to 8 inputs with a choice of SDI, DV, DVI*, Component (Y:U:V), S-video (Y/C) & Composite Video
- Balanced audio input with built in delayed function to ensure perfect synchronizing of video
- DV and SDI Input Boards feature audio de-embedder with dual channel balanced audio outputs
- Built in frame synchroniser and TBC for each channel, no external genlock is required for flicker free switching between all 8 inputs - in any format
- Advanced multi-screen monitor for confident preview of each source together with next source/effect preview and program output – with overlaid tally indicator
- Up to 4 live camera input virtual studio with optional Chroma Key card
- Integrated high-capacity removable hard disk video recorders, with 250GB hard drive, up to 18 hour DV format video
- Integrated Datavideo PD-1 power distribution centre provides a simple and secure solution for connecting power in the studio or in the field from a 12V source, such as a generator
- Easy Setup, breakdown and storage at any location. Designed to be "live-in-seconds"
- Anti shock padding protects the MS-900 during transit.

*DVI Input and External Genlock options will be available in the near future

FEATURES

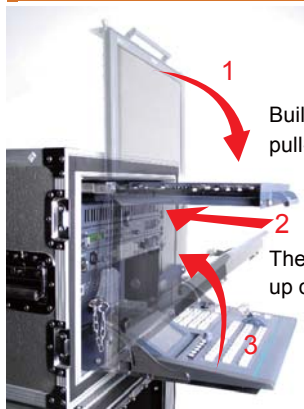

Built in TLM-170 pull-out 17" monitor

The Keyboard folds up during transport



Transit lock of the SE-900 keyboard to avoid transit damage.



DVI To PPT



SDI Overlay Board enables overlay of text and animations using a Character Generator Software such as Datavideo's CG-100.



4 Backgrounds



LOGOKEY (LUMAKEY)

DIAGRAM

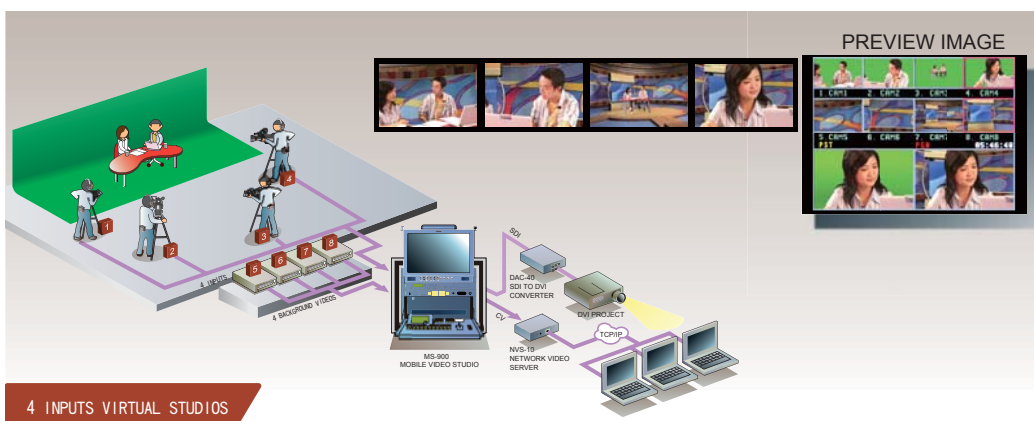
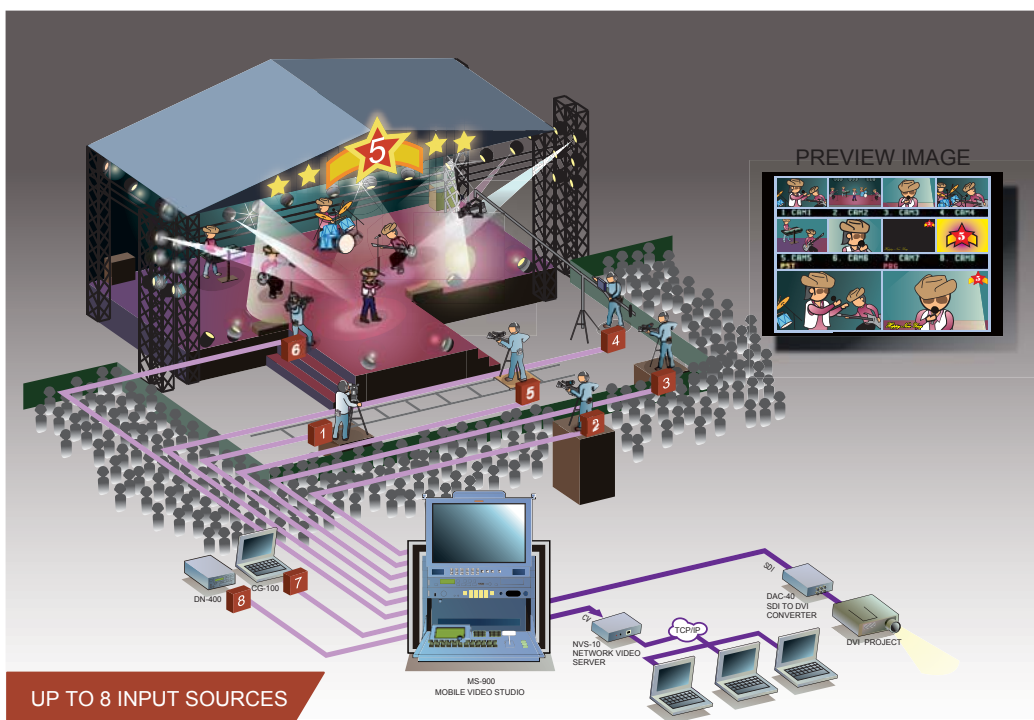

FRONT VIEW

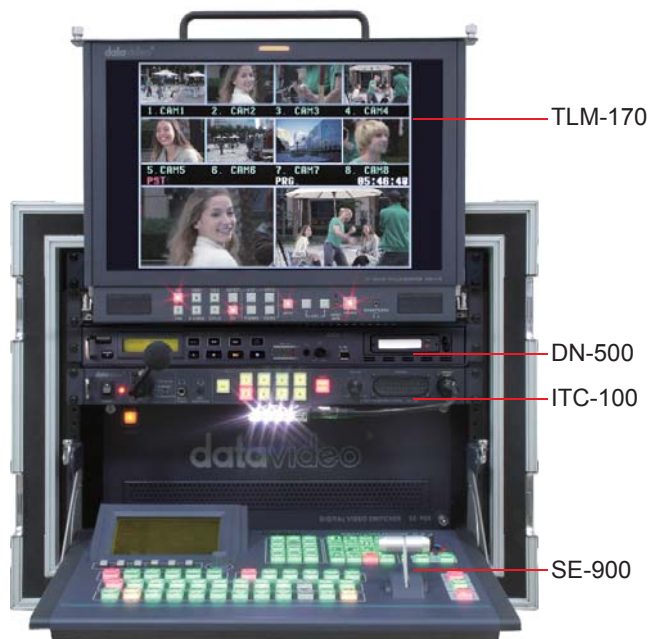

REAR VIEW



ACCESSORIES (OPTIONAL)



DAC-7

CV/ Y/C/ YUV & Audio inputs to
SDI embedded Audio Converter



CKL-200

Affordable Chromakey



DAC-40

HD/SD-SDI To DVI/VGA
Converter



HE-1

Removable USB
HDD Enclosure



NVS-10

Network Video Server



CB-4

50m 5-Pin Intercom Cable



CB-9

1.8m DVI-I Cable



CB-10

3m HD/SD YUV Cable



CB-21

1.8m DVI To VGA Cable



CG-100

SDI CG overlay Software

DIMENSIONS

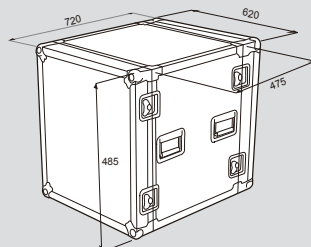
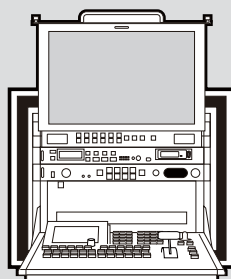

620(W) x 485(H) x 720(D) (mm)

Voltage: 100-240VAC, 50/60HZ,
1.6A/770mA, 240W Max
Weight: 68KG.

OPTIONAL BOARDS



Easy installation of optional boards including SDI, DVI, Down Stream Keyer, Genlock in and more

All inputs are synchronised internally, so no genlock is required, even between ordinary consumer camcorders/players and computer equipment

INCLUDED



External Control Board

RS-232, RS-422 & GPI control interface board allow easy integration with existing equipment that can be controlled such as tape recorders and players or presentation control panels



SDI Overlay Board

A down stream keyer (DSK) board offers both Internal and External keying options. Perfect for integration with character generator hardware/software such as Datavideo CG-100.



Multi-image Preview Output Board

The multi-image output display allows all inputs, master & next source output to be displayed on a single monitor, with superimposed tally and source information to assist the producer in a hectic live production environment.



Analogue and DV - Output Board

Output card for a range of popular video formats including DV (with embedded audio from the audio delay circuit) Composite Video, S-Video (Y/C) and Component (Y:U:V).

OPTIONAL



SDI Input Board

For users who work with SDI. The SDI input board also includes audio de-embedding to a balanced pair. Features a useful Composite Video monitor output, for easy connection to an external preview monitor



Analogue Video - Input Board

For users who require input from a range of popular analogue video formats including Composite Video, S-Video (Y/C) and Component (Y:U:V) - Built in Time Base Corrector synchronises each input - enabling non genlock equipment to be used without glitches. Features a useful Composite Video monitor output, for easy connection to an external preview monitor.



DVI-D & VGA Input Board

Connect a computer and switch between live video and popular computer applications such as presentation and more. Perfect for live events like worship and company presentations.

Features a Composite Video monitor output, for easy connection to an external preview monitor.



DV Input Board

For users who work with Digital Video (DV). The DV input board also de-embeds the audio to a pair of balanced outputs.



Four Channel Chromakey Board

Create a virtual Chromakey video studio with glitch-free switching between up to four video inputs. You can pair four foregrounds (e. g. talent/actor in front of the camera) and backgrounds (like virtual created backgrounds) - the internal Time Base Corrector takes care of synchronizing - even non genlock equipment, like ordinary consumer camcorders can be used.



SDI Output Board

For users who work with SDI. The SDI Output board also features a useful Composite Video monitor output, for easy connection to an external preview monitor.