

JVC®

The Perfect Experience / —

Super LoLux Network Mini-Dome

VN-V225 Series FIXED NETWORK DOME CAMERA

VN-X235 Series FIXED MEGAPIXEL NETWORK DOME CAMERA



V.NETWORKS

— High quality surveillance system with JVC's renowned digital processing technology which creates pure picture quality without digital dropouts over Ethernet

**MEGA
PIXEL**

VN-X235 Series

**Fine Focus
ADJUSTMENT**

**progressive
Scan**

**IR Cut Filter
Day/Night**

**PoE
Power over Ethernet**

**DUAL
STREAM**

**Bi-Directional
Audio**

Vandal-PROTECTED

■ 1.3 Megapixel High-Quality JPEG Stream

VN-X235 Series

Up to Quad VGA (1280x960) resolution images available for precise monitoring

■ MPEG-4/Motion JPEG Dual Stream

Simultaneous distribution of MPEG-4 and Motion JPEG images

■ Variable-Focal Lens for Accurate Viewing Angles, and Progressive Scan CCD for Precise Clear Images

■ Day/Night Function with IR Cut Filter

Automatic switching between day and night for secured round-the-clock surveillance

■ Bi-Directional Audio Support

Two-way audio communication is possible when a microphone and speaker are attached

■ Dust/Waterproof and Vandal-Protected Design

IP66-standard robust design suitable for outdoor monitoring system

■ Fine Focus Adjustment [Patent Pending]

Newly developed mechanism for finer and more accurate focus adjustment

■ Triple Axis Rotation for Flexible Lens Angle Adjustment

■ Open Architecture API for Easy Customization

Various settings and customization are possible via network

■ An Array of Features to Match Any Usage Environment

- Free shape privacy mask
- Built-in motion detection
- PoE / 24VAC power supply
- Bandwidth flexibility
- Optional heater unit for use in low temperatures down to -30°C
- JVC and Verint API compatibility
- Web based viewer and setup screen for quick setup and monitoring

Clear, Sharp Pictures in Any Situation

JVC's Network Mini-Dome Series cameras are an ideal solution where high quality surveillance is required. High-resolution images with low light sensitivity and a host of intelligent monitoring functions help you configure a reliable and more advanced security system.

Megapixel Image Quality with Over 700 TV Lines

(VN-X235 Series)

Up to Quad VGA (1280x960) resolution images (VN-X235 Series) and jaggy-free clear images delivered from a Progressive Scan CCD enable detailed and precise monitoring with high-quality pictures.



Under 1 Lux Super LoLux Sensitivity

The Mini-Dome Series incorporates a high-sensitivity CCD to deliver high quality color images even in low light situations. And with the True Day/Night Function, IR cut filter automatically switches between ON and OFF according to the ambient light or alarm trigger. Reliable round-the-clock surveillance is assured.



Color Mode

High-sensitivity CCD ensures color monitoring at:
0.4 lx (VN-V225, 50% AGC SUPER)
0.8 lx (VN-X235, 50% AGC SUPER)



Black & White

B&W mode ensures very low-light monitoring at:
0.03 lx (VN-V225, 50% AGC SUPER)
0.08 lx (VN-X235, 50% AGC SUPER)

Easy Wide-D Function

This function is equivalent to the conventional Wide Dynamic Range function, allowing pictures to be adjusted to identify details of the subject by adjusting gamma curve even in difficult backlit conditions.



Normal picture



Adjusted with Easy Wide-D

Digital PTZ with Preset Patrol (VN-X235 Series)



Original angle (Home)

Select up to 20 clipped areas from within the original image. These areas can be sequentially switched with "Auto Patrol", so the viewer concentrates only on the important zones.



Powerful Distribution Performance

MPEG-4/Motion JPEG Dual Stream

The Mini-Dome Series can stream both MPEG-4 and Motion JPEG images simultaneously. Up to 15fps distribution of Megapixel-size M-JPEG and VGA MPEG-4 is possible with VN-X235 Series while up to 30fps distribution of VGA images for VN-V225 Series is available.

Distribution Priority Option for JPEG Stream

Two distribution modes are available according to your environment. By controlling the frame rate and the number of accessible clients, it ensures stable monitoring all the time.

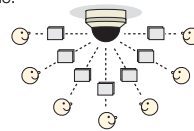

Priority to Client Number

Automatically adjusts the frame rate according to the number of clients accessed and assures distribution to all clients (up to 20).

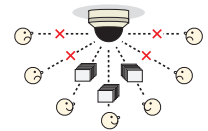

Priority to Frame Rate

Always maintains requested frame rate by clients though number of clients is limited by requested frame rate.

Bi-Directional Audio Communication

With a Mic In/Line Out connection, bi-directional audio communication is possible. In addition to viewing the camera spot, you can listen in on the area from a monitoring room. When an external speaker is attached, you can speak to or emit an alarm sound for visitors.

Monitoring with Bi-Directional Audio

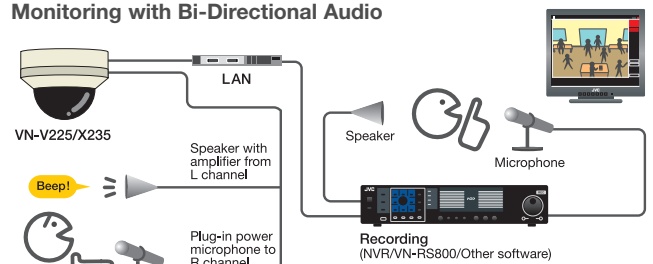

Compatible JVC recorders:
• VR-N1600U/E Series Network Video Recorder
• VN-RS800U (Free software for surveillance with up to 32 cameras)

Easy, Reliable Monitoring in Any Location

Designed for easy installation and use in various environments, the Mini-Dome Series assures versatile monitoring whether it is used indoors or outdoors. JVC's unique technologies to obtain precise image adjustment support maximum reliability.



Fine Focus Adjustment Technology

For assisting focusing to the finest point, the Variable-Focal lens now incorporates a newly developed focus gear mechanism (Patent Pending).

Patent Pending

New "Fine Adjust" mechanism

With a very subtle movement, finer, more accurate adjustment is possible.



Triple Axis Rotation

Triple axis rotation mechanism of the lens direction helps you to fix the angle accurately and easily. Pan, tilt, and rotation angles can be adjusted freely and independently.



Flush Mountable Easy Installation (VN-V225U/X235U)

Indoor type Mini-Dome Series is designed to be flush mountable so you can easily recess into the ceiling without using optional brackets.

Note: In the U.S., there are regulations regarding methods of flush mount installation. Please consult your regional sales branch for details.



Make a hole of $\phi 120\text{mm}$ and insert the camera's inner body into it.



When three metal levers are turned clockwise, springs work automatically to fix the unit firmly into the ceiling.



Attach the dome cover, and that's all.

JVC-Quality Vandal Protection

Robust Dome Cover: Using polycarbonate, a material offering superior intensity, heat-resistance and transparency, this dome cover remains damage-free against strong shocks. Severe durability tests have been conducted for each model; strong burden of over 50J* for VN-V225VPU/X235VPU Vandal-Proof model and over 15J* for VN-V225U/X235U Vandal-Resistant model.

* "J" stands for "Joule" which is the energy exerted by a force of one Newton acting to move an object through a distance of one meter.

Robust Body: Using die-cast aluminum for main unit, it assures complete vandal proofing. (VN-V225VPU/X235VPU)

IP66 Compliant: Designed to protect from water and dust, it's suitable for outdoor installation. (VN-V225VPU/X235VPU)



Monitor Output for Quick Angle Adjustment

A convenient Monitor Output is equipped. With an external monitor unit connected, you can easily check the camera angle on the spot during installation.

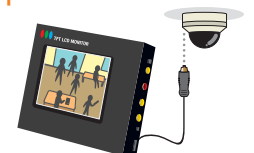

Series Comparison



	1.3 Megapixel	True Day/Night	Digital PTZ	Fine Focus Adjustment	Easy Flush Mount	PoE	Vandal Protection	Dust/Water Protection
VN-V225U		●		●	●	●	●	
VN-V225VPU		●		●		●	●	●
VN-X235U	●	●	●	●	●	●	●	
VN-X235VPU	●	●	●	●		●	●	●

Dimensions

VN-V225U/VN-X235U

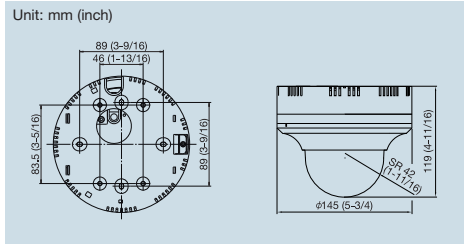

VN-V225VPU/VN-X235VPU

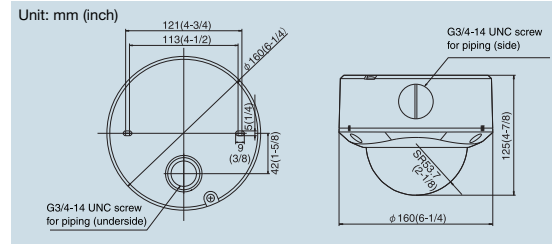

Optional Accessory

KA-ZH215U Heater unit



Specifications

	VN-V225U	VN-V225VPU	VN-X235U	VN-X235VPU
Image device	"Exview HAD CCD" 1/4" Progressive scan Approx. 330,000 pixels		"Exview HAD CCD" 1/3" Progressive scan Approx. 1,250,000 pixels	
Lens	3.8 x 2.8-10.5 mm varifocal, F1.2		3.0 x 3.0-9.0 mm varifocal, F1.2	
Angle of vision	f=2.8 mm: 73.78° (H) x 54.3° (V) f=10.5 mm: 20.6° (H) x 15.5° (V)		f=3.0 mm: 93.0° (H) x 68.4° (V) f=9.0 mm: 31.7° (H) x 23.8° (V)	
Day/Night	Automatic and Manual switching Day/Night IR cutoff filter			
Minimum illumination	0.4 lx (Color, 50%, AGC SUPER) 0.03 lx (B&W, 50%, AGC SUPER)		0.8 lx (Color, 50%, AGC SUPER) 0.08 lx (B&W, 50%, AGC SUPER)	
Camera angle adjustment	Pan 350°, Tilt ±80°, Rotation ±100°	Pan 350°, Tilt ±70°, Rotation ±175°	Pan 350°, Tilt ±80°, Rotation ±100°	Pan 350°, Tilt ±70°, Rotation ±175°
Picture compression	Motion JPEG MPEG-4: Part2 (ISO / IEC 14496-2), Profile: SP			
Picture resolutions	640 x 480, 320 x 240		1280 x 960 (JPEG), 640 x 480, 320 x 240	
Frame rate and streaming	Up to 30 fps M-JPEG and MPEG-4 simultaneously		Up to 15 fps M-JPEG and MPEG-4 simultaneously	
Compression levels	JPEG: Variable (VFS) 7 levels / Average (AFS) VGA 10 KB — 100 KB, QVGA 3 KB — 33 KB MPEG-4: Constant (CBR) / Variable (VBR), Bit rate adjustable 64kbps — 8000kbps		JPEG: Variable (VFS) 7 levels / Average (AFS) Quad VGA 40 KB-200 KB, VGA 10 KB — 100 KB, QVGA 3 KB — 33 KB MPEG-4: Constant (CBR) / Variable (VBR), Bit rate adjustable 64kbps — 8000kbps	
Image settings	Configurable AGC, Sens-up, Day / Night, Shutter speed, BLC, ALC, EV compensation, White balance (ATW / AWC), Gamma curve, Black level, Enhance range, Color level, Exposure value, Monitor type, Free shape Privacy mask, Time/date/camera ID overlay			
Digital PTZ	—		20 preset positions, Auto patrol, Auto return, 8x digital zoom	
Shutter speed	2 sec (Sens-up) to 1/10000 sec		1.5 sec (Sens-up) to 1/10000 sec	
Audio	Two-way (full/half duplex) or one-way External microphone input (plug-in power condenser mike) and output (line level) Audio compression: μ-law 64 kbps, AD/DA 16 bits Fs=8 kHz			
Security	3 levels password, IP address filtering			
Max. clients	20 simultaneous users, Unlimited users by multicast			
Alarm/Event management	Trigger: Built-in motion detection, External alarm input x 2 or Schedule Event: Pre/post recording, FTP sending, Notification over TCP/UDP, E-mail, External output x 2, sound output, preset position (VN-X235 series only) Pre/Post alarm buffer of 8MB			
Connectors	RJ-45 for Ethernet 10 Base-T/100 Base-TX/FULL/HALF/Auto negotiation Wires for 2 alarm input and 2 output RCA jack monitor out (for installation) Wires for alternative power connection Wires for mike in and line out			
Vandal protection	Vandal Resistant	Vandal Proof	Vandal Resistant	Vandal Proof
Dust and Water protection	—	Yes (IP66)	—	Yes (IP66)
Power	24 VAC (50 Hz / 60 Hz): 0.35 A 48 VDC (PoE): 7 W	24 VAC (50 Hz / 60 Hz): 0.35 A, 1.0 A with optional heater 48 VDC (PoE): 7 W	24 VAC (50 Hz / 60 Hz): 0.35A 48 VDC (PoE): 7 W	24 VAC (50 Hz / 60 Hz): 0.35 A, 1.0 A with optional heater 48 VDC (PoE): 7W
Operating temperature	-10 to 50°C / 14 to 122 °F (0 to 40°C / 32 to 104 °F recommended)	-10 to 50°C / 14 to 122 °F (0 to 40°C / 32 to 104 °F recommended) -30 to 50°C / -22 to 122 °F with optional heater (24 VAC power supply required)	-10 to 50°C / 14 to 122 °F (0 to 40°C / 32 to 104 °F recommended)	-10 to 50°C / 14 to 122 °F (0 to 40°C / 32 to 104 °F recommended) -30 to 50°C / -22 to 122 °F with optional heater (24 VAC power supply required)
Installation and maintenance	Web based setting tool, Camera search tool, Firmware update over HTTP			
Minimum web browsing environment	OS: Windows Vista Business (SP1), Windows XP Pro (SP2) / Home (SP2) CPU: Pentium 4, 1.5GHz Memory: 1GB, HDD space: 512MB Display and video card: 1024x768 True color (24bit or 32 bit) VRAM 8MB Browser: IE7.0 for Vista, IE6.0 for XP		OS: Windows Vista Business (SP1), Windows XP Pro (SP2) / Home (SP2) CPU: Pentium4, 2GHz Memory: 1GB, HDD space: 512MB Display and video card: 1600x1200 True color (24bit or 32 bit) VRAM 8MB Browser: IE7.0 for Vista, IE6.0 for XP	
Supported protocols	TCP/IP, UDP/IP, HTTP, FTP, ICMP, ARP, RTP, DHCP, SNMP, SMTP, DSCP, IGMP, IPv6, WSIP, AMX Device Discovery			
Video management software/hardware (not included.)	VR-N900U/1600U/1600E: JVC Network video recorder for viewing, recording and archiving up to 9/16 cameras. VN-RS800U: JVC free video management software for viewing, recording and archiving up to 32 cameras.(JPEG stream only)			
Dimensions	Ø145 mm x 119 mm (H) / Ø5-3/4" x 4-3/4"	Ø160 mm x 125 mm (H) / Ø6-1/4" x 4-7/8"	Ø145 mm x 119 mm (H) / Ø5-3/4" x 4-3/4"	Ø160 mm x 125 mm (H) / Ø6-1/4" x 4-7/8"
Weight (Approx.)	0.75kg / 1.65lbs	1.3kg / 2.87lbs	0.75kg / 1.65lbs	1.3kg / 2.87lbs
Option	—	KA-ZH215U : Heater unit	—	KA-ZH215U : Heater unit

"Exview HAD CCD" is a registered trademark of Sony Corporation. All brand or product names may be trademarks and/or registered trademarks of their respective owners
Copyright © 2009, Victor Company of Japan, Limited. All Rights Reserved.



DISTRIBUTED BY



Design and specifications subject to change without notice.



Victor Company of Japan, Ltd. has received ISO14001 Certification for environmental management and ISO9001 Certification for quality assurance management.

Printed in Japan
VEC-0330 VN-V225U/VN-X235U/VN-V225VPU/VN-X235VPU 2009/7

<http://www.jvc.com/vnetworks>

"JVC" is the trademark or registered trademark of Victor Company of Japan, Limited.