



FC-113

HDMI to 3G HD-SDI Format Converter



The **FC-113** is a high-performance format converter for HDMI signals. It converts an HDMI input signal to two identical SDI video with embedded audio signals.

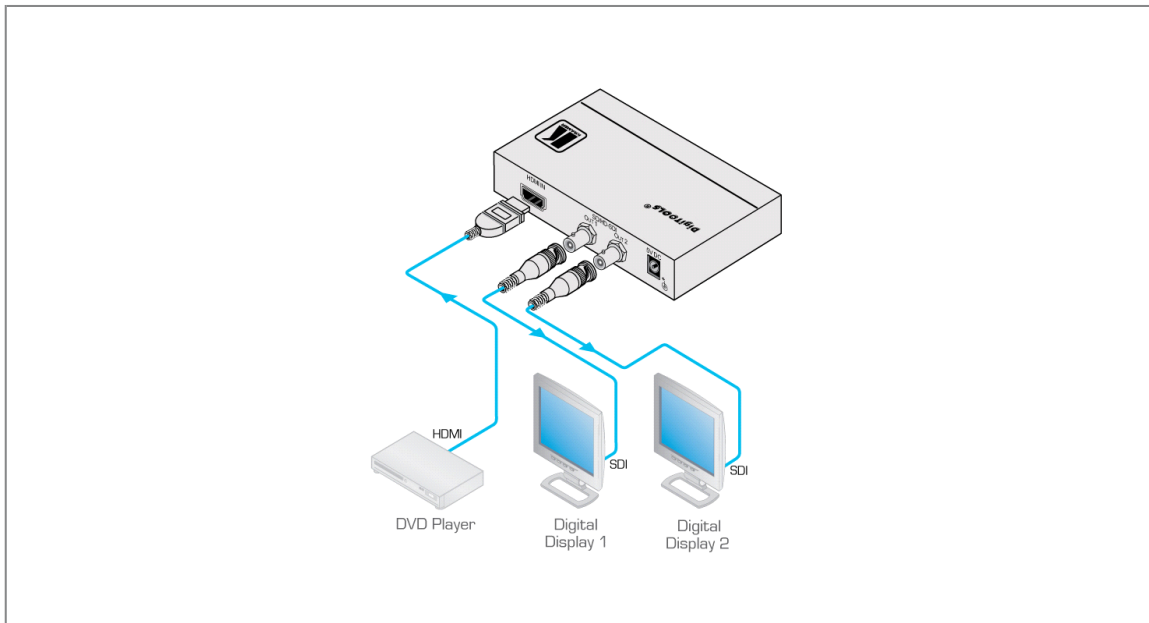



FC-113

FEATURES

- **Max. Data Rate** - 3Gbps.
- **HDTV Compatible.**
- **Multi-Standard Operation** - SDI (SMPTE 259M), HD-SDI (SMPTE 292M), and 3G HD SDI (SMPTE 424M).
- **No Frame Rate or Resolution Conversion.**
- **Active Input™ LED Reporting** - Green indicates standard definition (SDI), blue indicates a high-definition (HD-SDI) input signal, flashing indicates HDCP on the HDMI signal.
- **HDCP Encryption** - Since the HD-SDI standard does not support HDCP, the status LED flashes when an HDCP encrypted input signal is detected, indicating that the input signal cannot be converted.
- **Compact DigiTOOLS®** - 3 units can be rack mounted side-by-side in a 1U rack space with the optional RK-3T rack adapter.

TECHNICAL SPECIFICATIONS

INPUT: 1 HDMI connector.

OUTPUTS: 2 SD/HD-SDI, 3G HD-SDI on BNC connectors.

MAX. DATA RATE: Up to 3Gbps.

STANDARD COMPLIANCE: HDMI.

INPUT FORMATS: 525i, 625i; 1080p @23.98/24/25/29.97/30/50/59.94/60; 1080i @50/59.94/60; 720p @50/59.94/60.

INDICATOR LEDS: SD/HD, OUT, ON.

POWER SOURCE: 5V DC, 440ma.

DIMENSIONS: 12cm x 7.2cm x 2.4cm (4.7" x 2.8" x 1.0") W, D, H.

WEIGHT: 0.3kg (0.67lbs).

ACCESSORIES: Power supply.

OPTIONS: RK-3T 19" rack adapter.