



PT-4iREX

Infrared Repeater with External IR Sensor Input



The **PT-4iREX** is an infrared signal repeater that can operate at distances up to approximately 75m (240ft). This model extends infrared signals in areas where there is no direct line-of-sight for normal infrared signal operation.

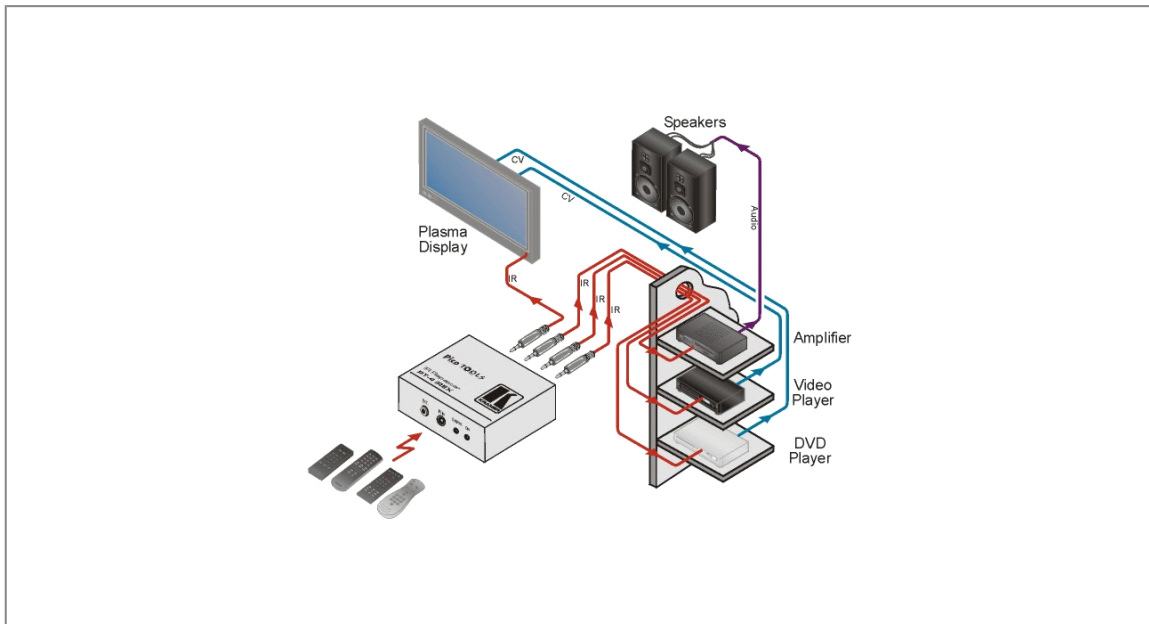



PT-4iREX

FEATURES

- **Input** - Built-in IR receiver and 3.5mm connector for external IR receiver at cable distances up to about 30m (100ft).
- **Outputs** - 4 outputs control up to 8 IR devices at cable distances up to approximately 75m (240ft).
- **Signal Application** - For use with all wireless IR signals (not hard-wired IR signals).
- **Ultra-Compact Pico TOOLS™** - 4 units can be rack mounted side-by-side in a 1U rack space with the optional RK-4PT rack adapter.

TECHNICAL SPECIFICATIONS

- INPUT:** 1 IR receiver.
- OUTPUTS:** 4 IR emitters on 3.5mm mini connectors.
- POWER SOURCE:** 12V DC, 95mA.
- DIMENSIONS:** 6.22cm x 5.24cm x 2.41cm (2.45" x 2.06" x 0.95") W, D, H.
- WEIGHT:** 0.15kg (0.55lbs) approx.
- ACCESSORIES:** Power supply; 3.5mm to IR emitter control cable (C-A35/IRE-10); 0.9m external remote IR receiver.
- OPTIONS:** RK-4PT 19" rack adapter; external IR receiver cables: C-A35M/IRR-3 and C-A35M/IRR-50; IR emitter cable: C-A35/2IRE-10 dual emitter.