



VP-14

4 Port RS-232 Port Extender



The **VP-14** is a port extender for RS-232 data signals. It sends data from any port to the other three.

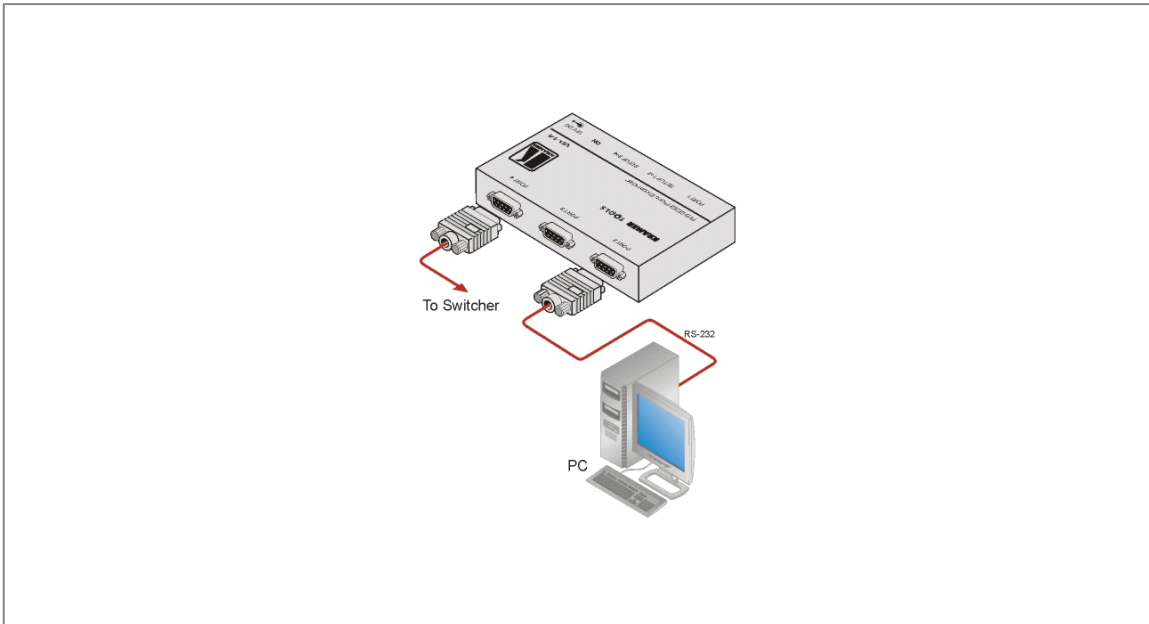



VP-14

FEATURES

- **Control** - DIP-switches for straight (flat) or crossed connection.
- **Compact Kramer TOOLS™** - 3 units can be rack mounted side-by-side in a 1U rack space with the optional RK-3T rack adapter.

TECHNICAL SPECIFICATIONS

RS-232 PORTS: 4 null-modem RS-232-C compatible TX/RX signals.

POWER SOURCE: 12V DC, 30mA.

DIMENSIONS: 12cm x 7.5cm x 2.5cm (4.7" x 2.95" x 0.98") W, D, H.

WEIGHT: 0.28kg (0.62lbs) approx.

ACCESSORIES: Power supply, mounting bracket.

OPTIONS: RK-3T 19" rack adapter.