

UVF MOUNT V2

Included:

(4) 1/4-20x3/8 socket cap 

(2) #6-32x3/8 socket cap 

(1) 1/4-20x1/4 socket cap 

(1) 3/16 allen wrench 

(1) 1/16 allen wrench 

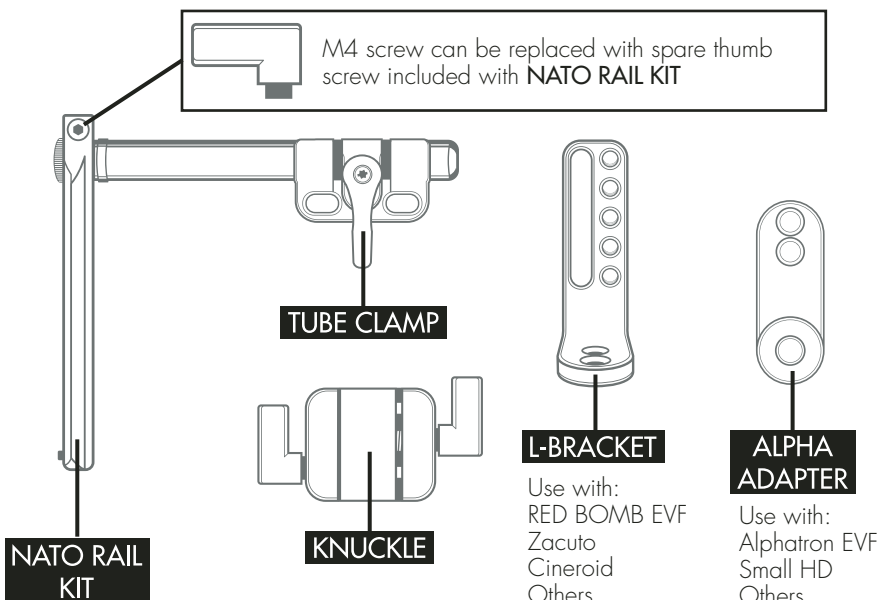

INSTALLATION

1. Select **NATO RAIL KIT** and remove **TUBE CLAMP**
2. Locate two **1/4-20 HOLES** spaced between 25mm-36mm on **CAMERA** or **CHEESEPLATE**, select **1/4-20x3/8 SOCKET CAPS**, tighten screws to **TUBE CLAMP** using allen wrench

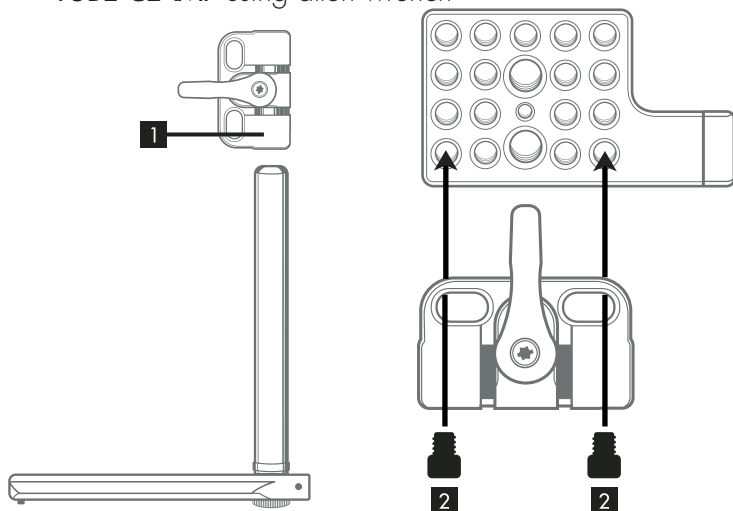

3. Slide **NATO RAIL KIT** into **TUBE CLAMP**, tighten using **THUMB SCREW**

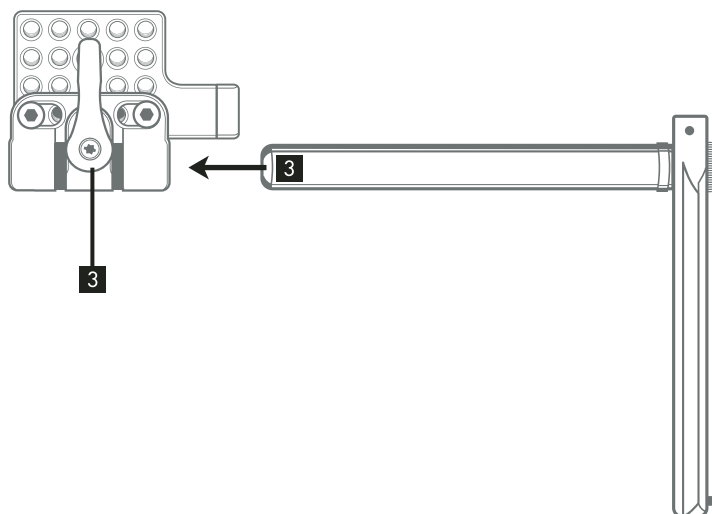

4. Select **L-BRACKET** or **ALPHA ADAPTER**, locate two **#6 SCREWS***, tighten to **KNUCKLE** using allen wrench
5. Slide **KNUCKLE** onto **NATO RAIL**

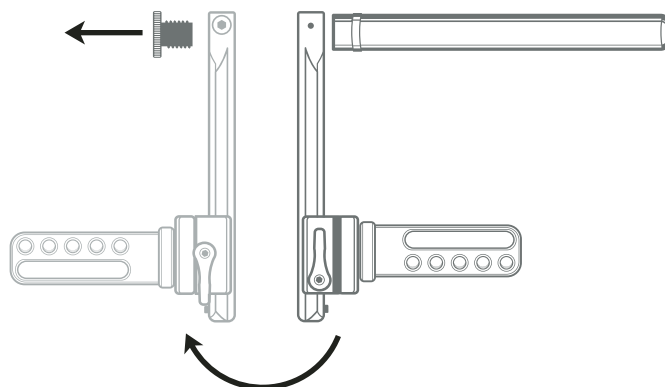
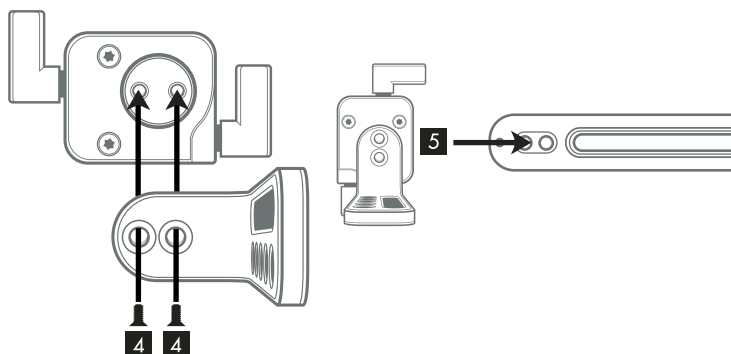

NOTE: To change viewfinder position, remove **ROD END CAP**, flip **NATO RAIL**, reinstall and adjust viewfinder using **KNUCKLE THUMBSCREW**

*Red thread locker material maybe present on **#6 SCREWS**.
This prevents loosening over time.